



The **CINE PRO** is a large dimension electrical screen available from 8 mt. till 12 mt. of width. Cine Pro is the best choice for cinemas, theatres and auditoriums, where there is the need to join a projection with the alternative to play a performance on the stage.

### TECHNICAL SPECIFICATIONS

- Electric **BOTTOM ROLLER** screen that assures perfect flatness
- Safer descent of the roller thanks to the steel cables and additional new **SAFETY MECHANISM** which stops motor in case an obstacle is hit during rolling down
- Screen housing standard in **BLACK** colour RAL 9005 – *optional* available in white colour (papyrus RAL 9018)
- Available in **bespoke sizes** – *optional* black side borders and black top drop
- Equipped with a **SAFETY SYSTEM** that prevents dropping down of the bottom roller in case of failure
- Nr. 5 new ceiling mounting brackets for an easier fixing (included)
- Truss mounting brackets (*optional*)

**DETAIL OF THE RIGHT SIDE**



Ceiling mounting brackets



n.1 On/off switcher



Kit RF Remote control with external receiver



Interface switch 12 volt



Low voltage contact interface

**INCLUDED**

**OPTIONAL** pag 62-63



## JUST PROJECTORS

### CINE PRO CLOSED

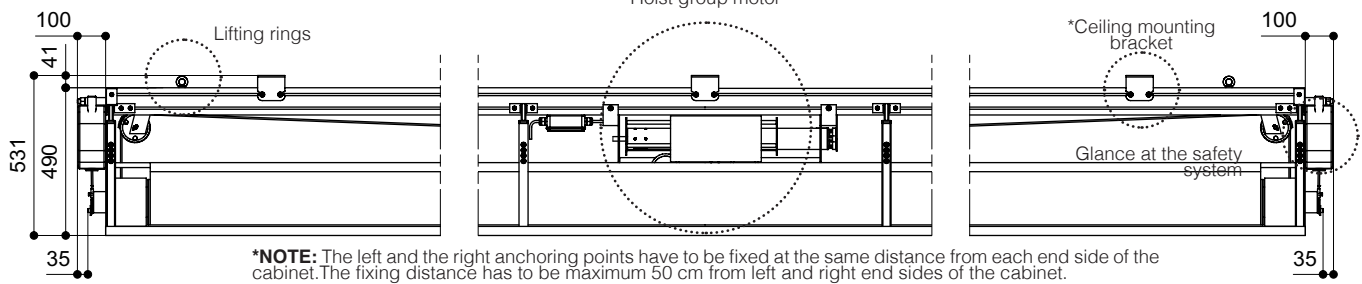

### CINE PRO OPEN

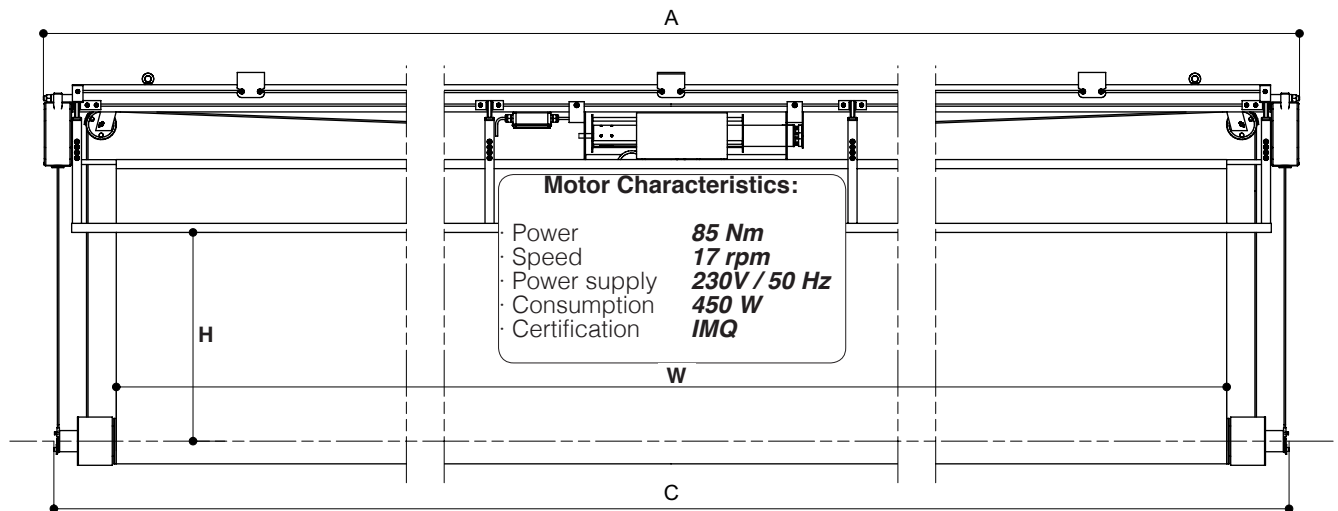

### HOUSING GLANCE

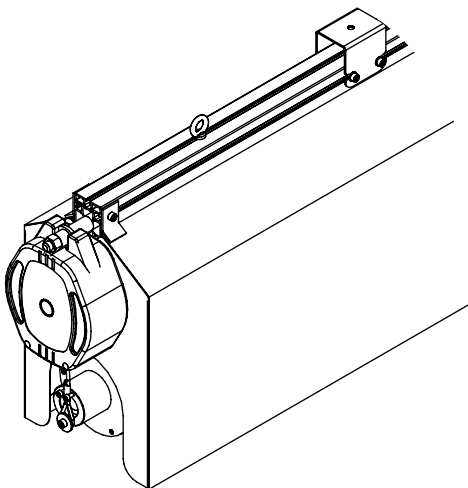

### HOUSING SIDE VIEW

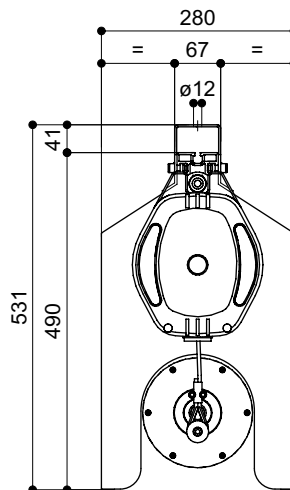

### HOUSING FRONT VIEW

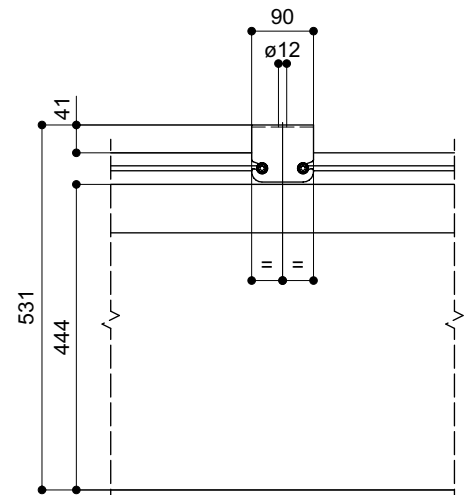

### DIMENSIONS measures in cm

Viewing area (WxH)	Overall dimensions A - C	Approx. net weight (Kg)	Approx. gross weight (Kg)	Rolling down/up time (sec)
800 x 450	858 - 851	227	491	59
900 x 500	958 - 951	249	554	65
1000 x 550	1058 - 1051	270	614	71
1100 x 600	1158 - 1151	292	680	78
1200 x 650	1258 - 1251	314	746	85

### PROJECTION CLOTHS

Front projection surfaces	Gain	Rear projection surfaces	Gain
White*	1.2	Rear Plus*	1.1
Microholes*	1.0	Front Rear*	0.9

\*Weldings on the projection surface

**Warranty:** 5 years on the motor - 24 months on the other components

ENGINEERED LIKE NO OTHER SCREEN IN THE WORLD  
[www.screenint.com](http://www.screenint.com)

