

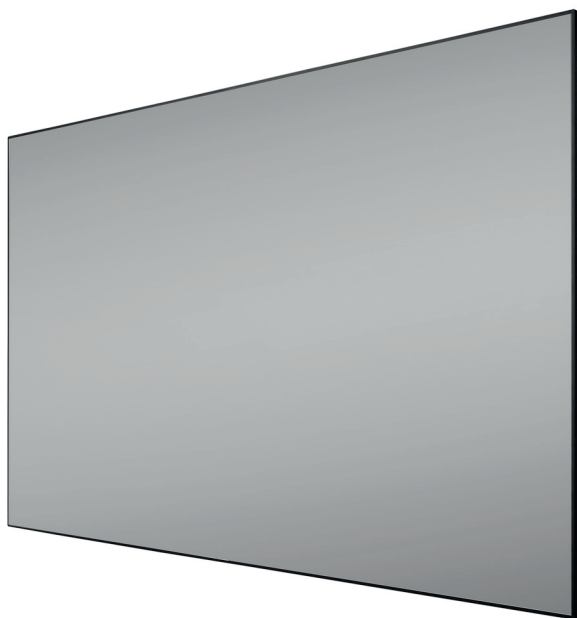

# Operating instructions

## celexon CLR HomeCinema UST Frame Screen



Thank you for purchasing this product.

For optimum performance and safety, please read these instructions carefully before connecting or operating this product. Please retain these instructions for future reference.

## WARNINGS

The purpose of this manual is to familiarize you with the product. Please keep these instructions in a safe place so that you can access it at any time.

- Please note the enclosed data sheet with further safety and usage information before installation.
- Do not start with the assembly before reading the complete instruction manual ensuring that you have fully understood it.
- This product should only be installed by qualified personnel with mechanical and electrical engineering knowledge.
- Carry out the installation with another person to ensure safe assembly.
- Remove the product from its packaging and remove all packaging material. Make sure that there is no packaging material on or in the product. If you notice any damage to the packaging, also check whether there is any damage to the product. If you notice any external damage to the unit or any unexpected or unusual functioning, the product must not be used any further. Immediately contact the dealer from whom you purchased the product or celexon directly (Web: [www.celexon.co.uk](http://www.celexon.co.uk), Mail: [info@celexon.co.uk](mailto:info@celexon.co.uk)) for further information.
- To ensure trouble-free operation, the product may only be used indoors. It is NOT suitable for outdoor use.
- The use of the appliance and accessories is forbidden to children under 16 years of age.
- Ensure that no children play with the appliance or are in the vicinity without supervision.
- Conversion or modification of the product impairs product safety.
- Caution: Risk of injury! Never carry out repair yourself!
- This product can only be used under the standard technical parameters.
- Do not use the product near gas or water appliances or in a dusty environment.
- Handle the product with care. It can be damaged by knocks, blows or falling from even a small height.
- Keep the product away from moisture and heat.
- Never immerse the product in water or other liquids.
- Use the product only in its intended manner. Use for any other purpose may damage the product or its surroundings.
- Tighten the screws, but do not overtighten them. Overtightening the screws (e.g. by using a cordless screwdriver) can cause damage and affect the secure hold of the screen.

- Suspended loads must be checked for strength and load-bearing capacity at least twice a year.
- Failure to observe the above instructions may result in personal injury and damage to the product or equipment connected to it. Incorrect installation or use may also invalidate the warranty.
- If you are unsure about the use of the product, please contact specialist personnel, your dealer or celexon directly (Web: [www.celexon.co.uk](http://www.celexon.co.uk), Mail: [info@celexon.co.uk](mailto:info@celexon.co.uk)).
- Technical changes and errors expected.

The manufacturer accepts no responsibility for damage to property or personal injury, if the screen is used outside the recommended specifications, or in the event of improper installation. **Do not use this screen in the vicinity of heaters or air conditioners. Also, do not mount the product in direct sunlight or in front of a window.** Due to the temperature-sensitive PVC surface, the projection screen fabric may be permanently damaged.

We recommend that you wait approx. 2 hours after delivery before installing the projection screen. This way you will allow the screen to acclimatise. If the screen is brought from a cold to a warm environment, we recommend waiting approx. 24 hours before setting it up. In order to be able to stretch the fabric optimally on the frame, the room temperature or the product temperature should be 18 - 24 degrees.

Please **avoid any stains on the surface of the screen.** These may not be able to be removed.

- Be sure to note the front and back of the fabric when attaching.
- Please check ALL parts for damage or scratches before assembling!
- The fabric must **ONLY** be assembled on a soft, padded surface. The frame coating and the delicate fabric may otherwise be scratched.
- For a permanent flatness, observe the following instructions.
  1. Do not touch the projection screen surface with your hands.
  2. Do not fold or crease the projection screen surface under any circumstances.
  3. Do not paint or write on the projection screen surface.

## DISCLAIMER

The information in this document is subject to change without notice by the manufacturer. Changes will be added to subsequent versions of this manual. Errors expected.

## CARE INSTRUCTIONS

NEVER clean the screen with alcohol or other cleaning agents containing solvents. Use only a soft and clean, dry cloth. If necessary, lightly wipe dust off the surface of the fabric in an exclusively horizontal direction. If necessary, use only clear, max. lukewarm water to remove dirt from the surface with very little pressure.

Avoid contact with sharp or pointed objects as these could permanently damage the projection screen surface. This CLR surface is very sensitive and creases etc. cannot be removed!

For further instructions, please refer to the enclosed projection screen instructions.

## IN THE BOX



(A) 2 x Horizontal frame profile (two-piece)

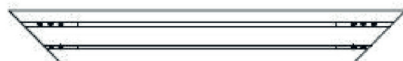

(B) 2 x Vertical frame profile (one-piece)



(C) 2 x Horizontal frame cover (two-piece)



(D) 2 x Vertical frame cover (one-piece)



(E) 4 x Corner connector



(F) 1 x Projection screen fabric



(G) 1 x Protective foam sheet



(H) Tension rod

2 x Long for vertical Profile  
4x Short for horizontal Profile

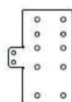

(I) 2 x Connecting  
bracket for central  
frame profiles



(J) 4 x Connecting  
bracket for corner  
frame profile

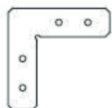

(K) 4 x Connector  
L-bracket



(L) 1 x Support strut



(M) 2 x Tension springs



(N) 12 x Sets Ø5x18  
screws & sowels



(O) 40 x M6x8  
screws



(P) 4 x M5x5  
screws



(Q) 20 x M5x5  
screws



(R) 4 x Wall moun-  
ting bracket x4



(S) 1 x Hexagon  
socket spanner

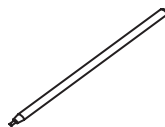

(T) 1 x Clamping  
tool

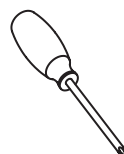

(U) 1 x Cross  
screwdriver



(V) 2 x Protective  
gloves

## STEP 1: ASSEMBLY FRAME

1. First plug both parts of the set (A) into each other.

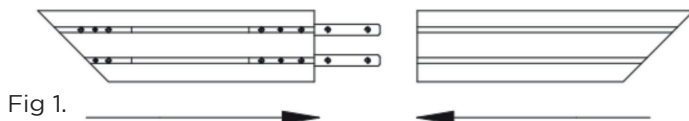

2. Connect both parts with the connecting bracket (I) and fix this with the screws (O).

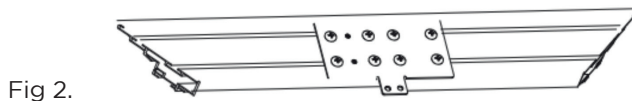

- 3 / 4. Place a connecting bracket(J) (Fig. 3) on both ends of each vertical frame profile(B).and screw it loosely with only one screw (O) per bracket (Fig. 4).

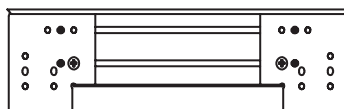

5. Turn the vertical frame profile (B) so that the back is on top. Now align the L-Brackets (K) on both ends of each vertical frame profile (B). Make sure that the bracket is in the correct groove (see fig. 5).

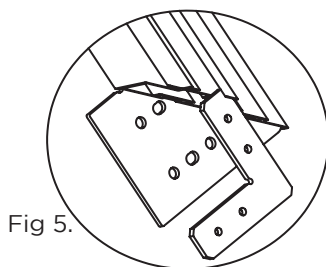

6. Afterwards, the already assembled horizontal frame profiles (A) can be connected to the vertical profiles (B).

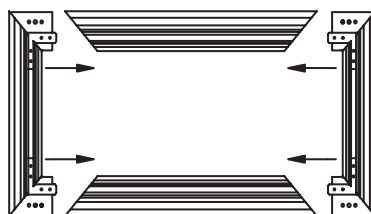

7. Fix the frame by screwing the four screws (Q) into each L-Bracket. Make sure that as soon as one bracket is fixed you do the diagonally opposite bracket next.

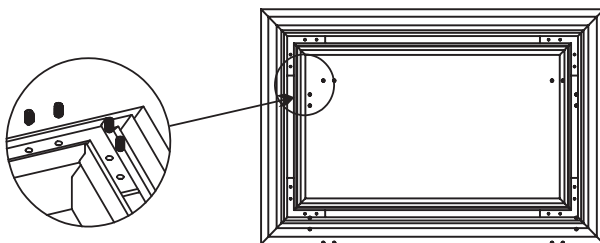

Fig 7.

8. Insert the support strut (L) to the centre of the length of the frame (according to fig. 8) and fix it with the screws (P) to the connecting bracket (I).

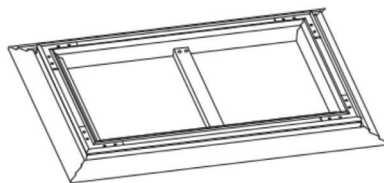

Fig 8.

9. Carefully turn the assembled frame over with 2 people, so that the connecting brackets (J) are on top. Screw the screws (O) into the connecting brackets and tighten them. Make sure that you always tighten the opposite side first. Then tighten the screws on the inside with the Allen key (S)

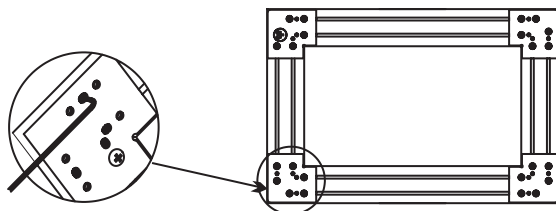

Fig 9.

**Please note: During the last frame assembly steps, it must be ensured that all frame parts are mitred to fit and tightened. If there are small gaps in the mitre, the cover frame cannot fit flush and unsightly joints will appear in the frame corners. As soon as you find small gaps in the mitre, loosen all fasteners and connecting brackets, push the frame parts together and gradually re-tighten the loosened components.**

## STEP 2: FABRIC ATTACHMENT

We recommend that you carry out the following steps with a second person.

**Caution: The projection screen surface is extremely sensitive!** Please carry out the installation of the projection screen surface with the utmost care. Take care not to bend the projection screen surface and do not touch it. Use the enclosed protective gloves (V) for mounting.

1. Lay the protective foam sheet (G) on a flat surface and secure the corners, ideally with a few strips of painter's masking tape to prevent the underlay from rolling in. Roll out the projection screen fabric (F) centrally - The projection side must be facing downwards.

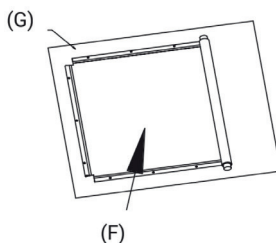

Fig 10.

2. Carefully push the tension rods (H) into the outer tabs of the projection screen fabric: 1x long tension rod each for short frame sides, 2x short tensioning rods per long fabric side. The rods must not be pushed through fabric one over the other, but butt against each other in the middle. Then lay the previously built frame with the flat front side onto the centre of the projection screen fabric.

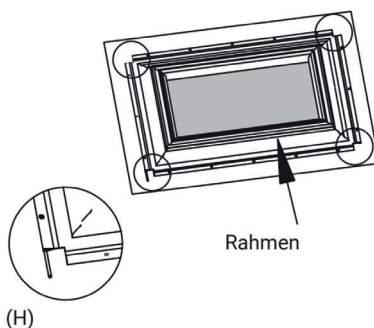

Fig 11.



3. Use the tensioning tool (T) and the tensioning springs (M) to attach the projection screen surface to the frame. Start hooking the tension springs onto the tensioning rods at the four corners and pull the tensioning tool to pull the springs into the groove in the frame

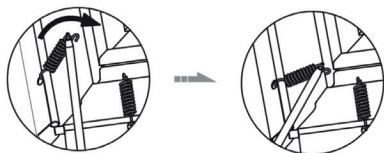

Fig 12.

4. Once all four corners are attached with two springs each, place a spring in the centre of each length. Please also note here that you do the opposite side first and only then move on to another point. Continue with the whole fabric and smooth it down if necessary. After the first springs have been set, check that the frame is absolutely centred on the corners and sides of the fabric. If necessary, lift the frame slightly and pull the fabric out of the surface. The fabric is cut very precisely to fit the frame and a slight misplacement may result in the fabric not being able to be fitted properly. Here you have to work very precisely and calmly with sufficient space. The corners in particular may have to be loosened and worked around the frame again in such a way that no ripples occur. The CLR material is comparatively stiff and may need to be reworked in the corners after a few days.

To do this, place the frame on the protective sheet, loosen the springs in the corners again and, wearing gloves, work on the affected corner so that no more ripples are visible. Then re-tension the springs around all the corners concerned, one after the other.

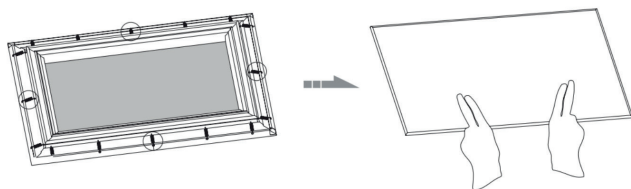

Fig 13.

### STEP 3: ATTACHING THE COVER FRAME

1. Start with the horizontal cover frame (C). A cover frame consists of two parts that are placed next to each other on a long side of the frame.

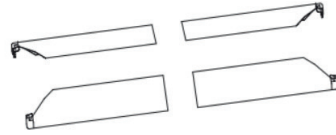

Fig 14.

2. Place all four parts on the top and bottom of the frame.

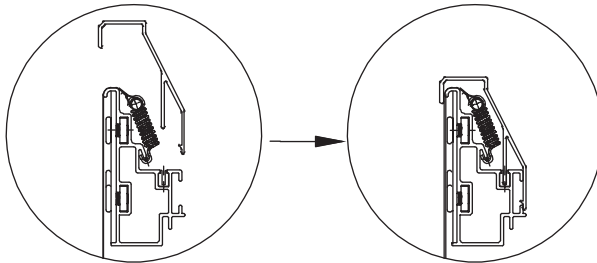

Fig 15.

3. Now insert the corner connectors (E) into the ends of the cover frames and then place the vertical cover frames (D) on the short frame sides.

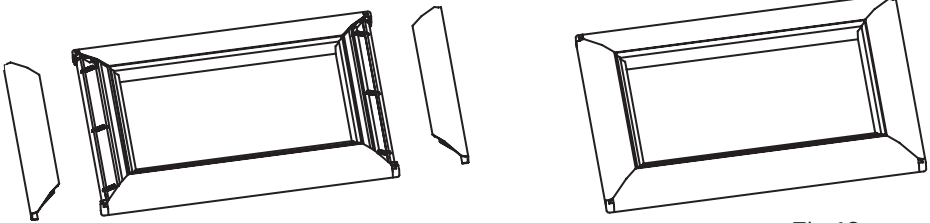

Fig 16.

## STEP 4: MOUNTING TO THE WALL

The celexon UST frame screen is equipped with sliding wall mounting brackets (R) that allow flexible mounting. Please use the enclosed dowels and screws (N) for mounting to a solid stone wall. For other supporting structures you may need other mounting material.

1. The mounting brackets should preferably be placed at a distance of  $\frac{1}{4}$  of the total frame width from the edge of the frame. (Example: Frame width 200cm -> distance between mounting brackets and edge of frame = 50cm). Insert the upper and lower mounting brackets once into the still lying screen and measure the distance between the upper and lower brackets. Before mounting, loosen the safety catches of the two lower brackets (Fig. 18).

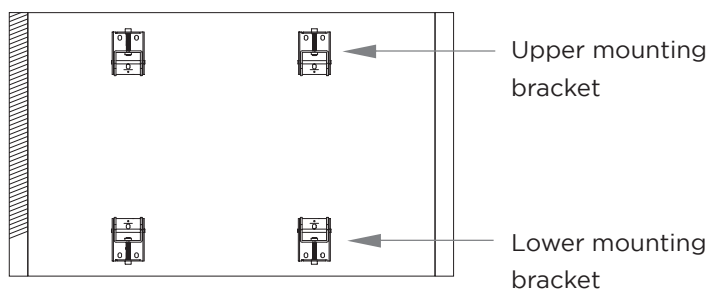

Fig 17.

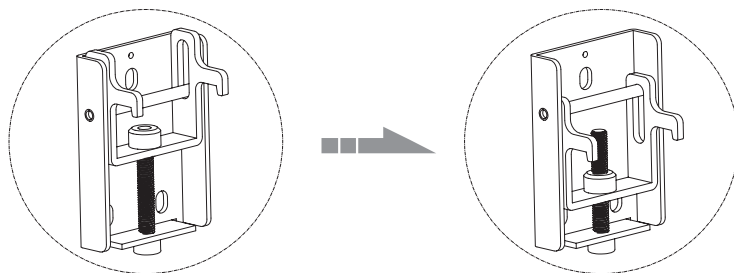

Fig 18.

2. Transfer the hole size of the brackets and the distance between the upper and lower brackets to your wall, drill the corresponding holes and insert the plastic dowels. Then mount the brackets on the wall.

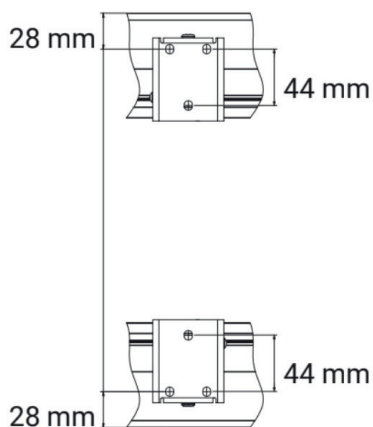

Fig 19.

3. Then hang the frame screen on your wall and make sure that the (top) brackets engage in the groove provided in the frame. Then tighten the fall protection of the lower and upper mounting brackets. After mounting, please check whether the screen hangs absolutely horizontally, slight adjustments can be made by using the safety catches. The assembly is now complete.

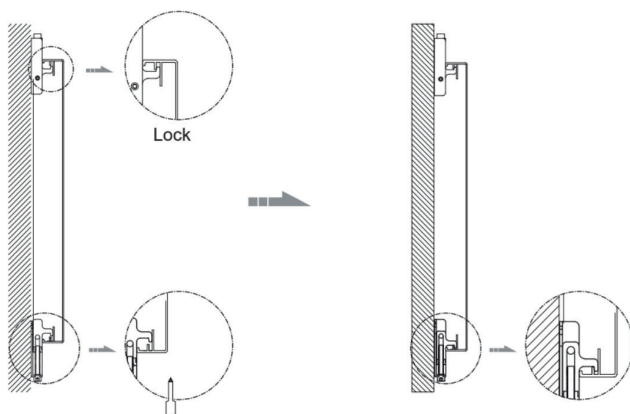

Fig 20.