

Operating instructions

celexon Electric ceiling recessed projection screen Expert | Expert XL

Electric Expert

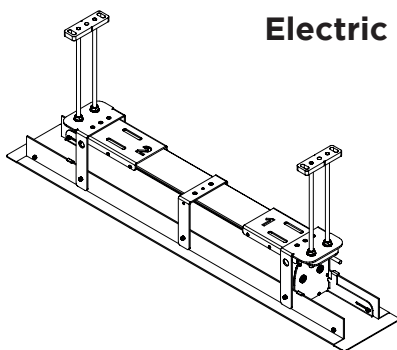

Electric Expert XL

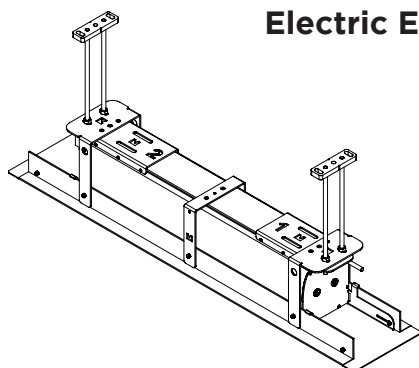

Thank you for purchasing this product. For optimum performance and safety, please read these instructions carefully before connecting or operating the product. Please retain these instructions for future reference.

WARNINGS

The purpose of these operating instructions is to familiarise you with the operation of this product. Keep the manual in a safe place so that you can refer to it at any time.

- Before installation, please refer to the data sheet for further safety and use instructions.
- Do not start installation until you have read and understood the complete operating instructions.
- Carry out the installation with another person to ensure safe installation.
- Remove the product from its packaging and remove all packaging material. Make sure that there is no packaging material on or in the product. If you notice any damage to the packaging, also check whether there is any damage to the product. If you notice any external damage to the unit or any unexpected or unusual functioning, do not use the product any further. Contact the retailer where you purchased the product immediately, or celexon directly (Web: www.celexon.co.uk, Mail: info@celexon.co.uk) for further information.
- To ensure trouble-free operation, the product may only be used indoors. it is NOT suitable for outdoor use.
- The use of the screen and accessories is forbidden to children under 16 years of age.
- Ensure that no children play with the screen or are in the vicinity without supervision.
- Conversion or modification of the product impairs product safety.
- Caution: Risk of injury! Never open the product without authorisation. Never carry out repairs yourself!
- Do not use the product near leaking gas, water or in a dusty environment.
- Handle the product with care. It can be damaged by knocks, blows or falling from even a small height.
- Keep the product away from moisture and heat.
- Never immerse the product in water or other liquids.
- Use the product only in its intended manner. Any use for any other purpose may damage the product or its surroundings.
- Tighten the screws but do not overtighten them. Tightening too tight (e.g. by using a cordless screwdriver) can cause damage and affect the secure hold of the screen.
- Suspended loads must be checked for strength and load-bearing capacity at least twice a year.

- Children should not use the screen or play under it unsupervised.
- Caution: Risk of injury! The unit closes flush and firmly, keep fingers, hands or other small parts away from the opening.
- All supply lines and cables must not be subjected to additional loads and must be laid in such a way that they are not damaged or crushed.
- Failure to observe the above instructions may result in personal injury and damage to the product or equipment connected to it. Incorrect installation or use may also invalidate the warranty.
- If you are unsure about the use of the product, please contact your specialist personnel, your dealer or celexon directly (Web: www.celexon.co.uk, Mail: info@celexon.co.uk).
- Technical changes and errors excepted.

The manufacturer accepts no responsibility for damage to property or personal injury, if the screen is used outside the recommended specifications, or in the event of improper installation. Do not use this screen in the vicinity of heaters or air conditioners. Also, do not mount the product in direct sunlight or in front of a window. Due to the temperature-sensitive PVC surface, the projection screen fabric may be permanently damaged.

We recommend that you wait approx. 2 hours after delivery before installing the projection screen. This will allow the screen to acclimatise, especially if it is moved from a cold to a warm environment or vice versa.

Please avoid any stains on the surface of the canvas. These may not be able to be removed.

The positions of the end points are already optimally set at the factory and should not be changed. Especially with motorised screens, the entire length of the fabric should always be used in order to achieve the best flatness. An adjustment of a few cm of the end switch-off points should only be made by persons with specialist knowledge and in consultation with the manufacturer. Incorrect adjustment can result in damage to the projection surface.

DISCLAIMER

The information in this document is subject to change without notice by the manufacturer. Changes will be added to subsequent versions of this manual. Errors excepted.

TECHNICAL DATA

Voltage: 220 V~240 V, 50 Hz

Consumption: 156 W (MAX)
0.4 W (standby)

IN THE BOX - ELECTRIC EXPERT RECESSED CEILING SCREEN

When you open the packaging, please check that **ALL** the components listed below are included. If one or more components are missing, please contact the dealer from whom you purchased the product.

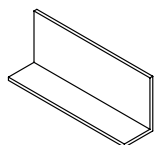

2x A

White long „L“ profiles - pre-cut

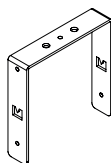

1x B

C-shape mounting bracket

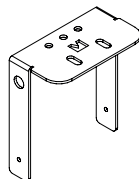

2x C

C-shape mounting bracket with mounting

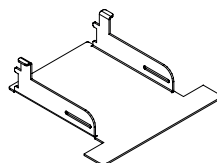

2x D

Access panels

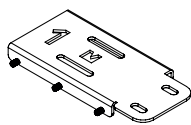

1x E

Mounting plate „1“ for screen housing

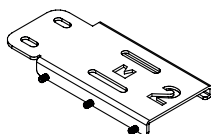

1x F

Mounting plate „2“ for screen housing

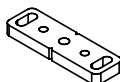

2x G

Ceiling mounting plates



12x H
M8 nuts

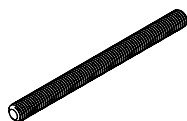

4x I

Threaded rods
M8x1000mm



4x J

Collar nuts M8



8x K

Washers
Ø25x2 M8



4x L

Round head screws



6x M

Countersunk screws
M4x10mm



10x N

Self-locking nuts M4

DIMENSIONS - ELECTRIC EXPERT RECESSED CEILING SCREEN

Front view:

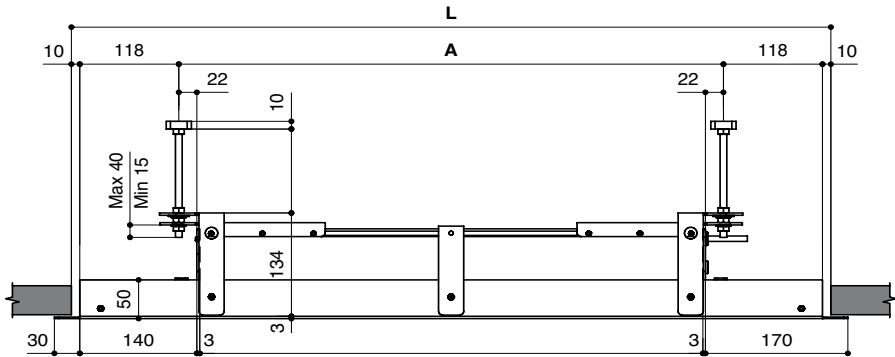

Side view:

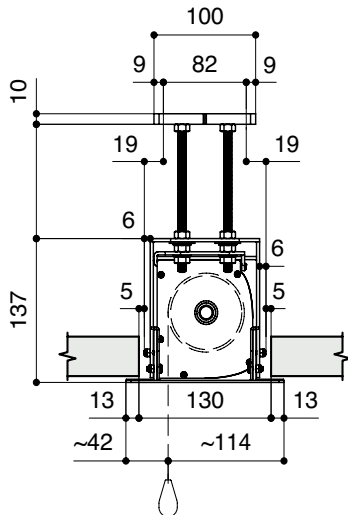

Top view of the ceiling mounting plate:

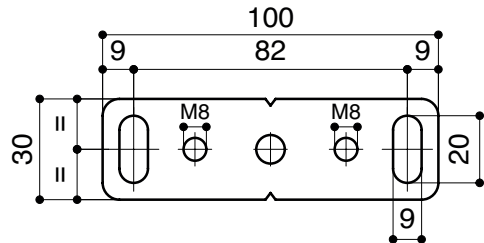

All dimensions are in mm.

DIMENSIONS - ELECTRIC EXPERT RECESSED CEILING SCREEN

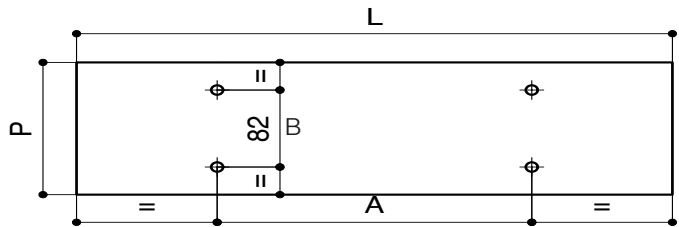

Cut-out dimensions for false ceiling and fixing points

Dimensions of the mounting points of the ceiling mounting plates

Model	A (mm)	B (mm)
Electric Expert (standard incl. 50 mm black edges)	Viewing area width + 215	82
Electric Expert (without black borders)	Viewing area width + 115	82
Electric Expert Tensioned	Viewing area width + 405	82

Dimensions of the ceiling cut-out in the false ceiling

Model	L (mm)	P (mm)
Electric Expert (standard incl. 50 mm black edges)	Viewing area width + 470	130
Electric Expert (without black borders)	Viewing area width + 370	130
Electric Expert Tensioned	Viewing area width + 370	130

All dimensions are in mm.

IN THE BOX - ELECTRIC EXPERT XL RECESSED CEILING SCREEN

When you open the packaging, please check that **ALL** the components listed below are included. If one or more components are missing, please contact the dealer from whom you purchased the product

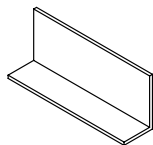

2x A

White long „L“ profiles - pre-cut

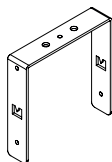

1x B

C-shape mounting bracket

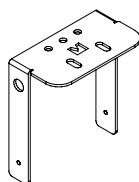

2x C

C-shape mounting bracket with mounting

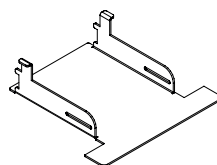

2x D

Access panels

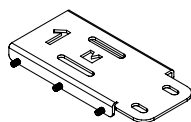

1x E

Mounting plate „1“ for screen housing

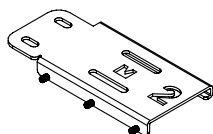

1x F

Mounting plate „2“ for screen housing

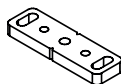

2x G

Ceiling mounting plates



12x H

M8 nuts



4x I

Threaded rods
M8x1000mm



8x J

Collar nuts M8



4x K

Washers
Ø25x2 M8



4x L

Round head screws
M4x12mm



6x M

Countersunk screws
M4x10mm



10x N

Self-locking nuts M4

DIMENSIONS - ELECTRIC EXPERT XL RECESSED CEILING SCREEN

Front view:

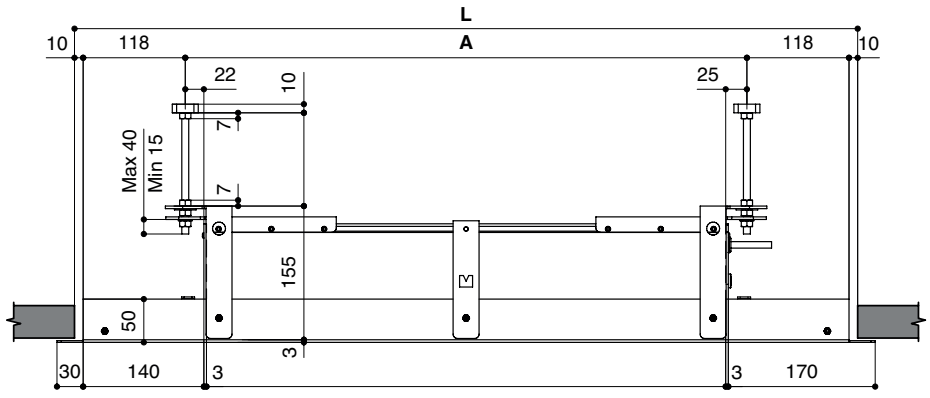

Side view:

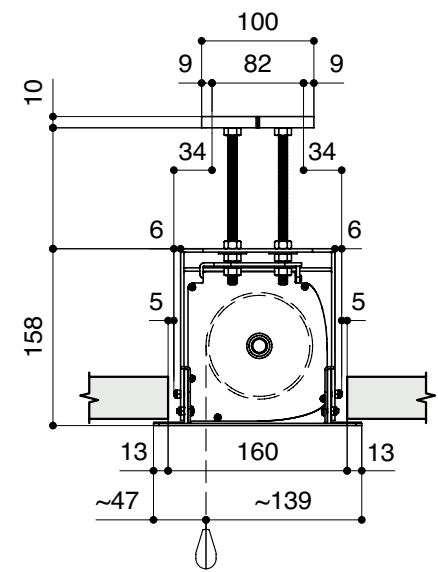

Top view of the ceiling mounting plate:

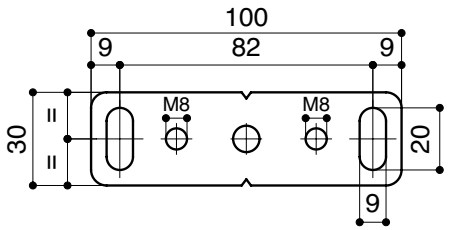

All dimensions are in mm.

DIMENSIONS - ELECTRIC EXPERT XL RECESSED CEILING SCREEN

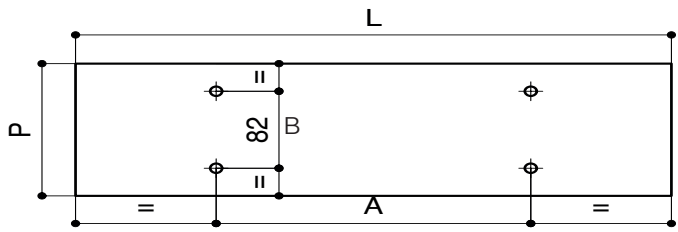

Cut-out dimensions for false ceiling and fixing points

Dimensions of the mounting points of the ceiling mounting plates

Model	A (mm)	B (mm)
Electric Expert XL (standard incl. 50 mm black edges)	Viewing area width + 230	82
Electric Expert XL (without black borders)	Viewing area width + 130	82
Electric Expert XL Tensioned	Viewing area width + 422	82

Dimensions of the ceiling cut-out in the false ceiling

Modell	L (mm)	P (mm)
Electric Expert XL (standard incl. 50 mm black edges)	Viewing area width + 485	160
Electric Expert XL (without black borders)	Viewing area width + 385	160
Electric Expert XL Tensioned	Viewing area width + 677	160

INSTALLATION INSTRUCTIONS EXPERT & EXPERT XL

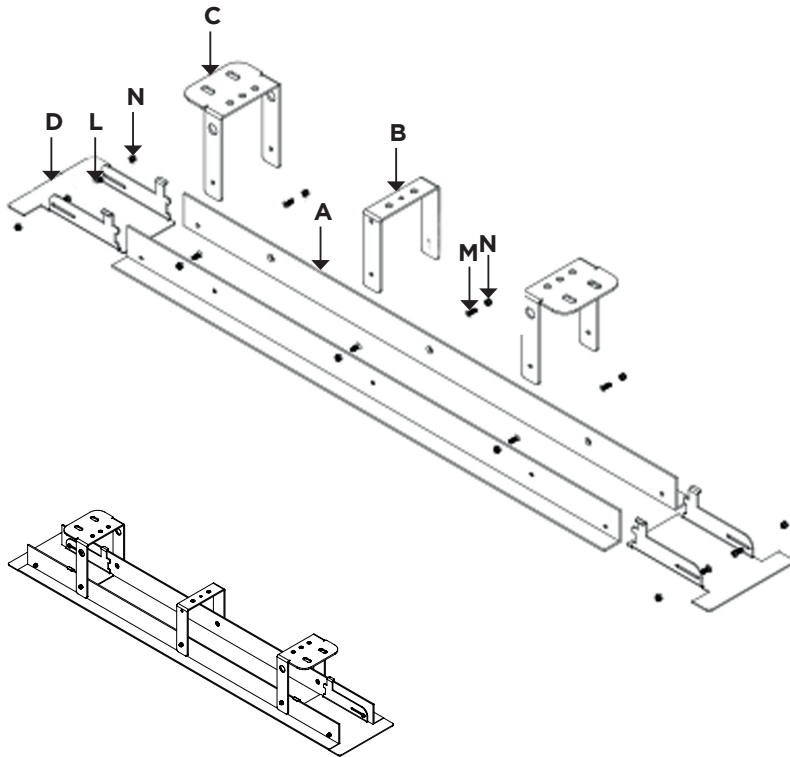

Make sure that parts **B** and **C** are assembled at right angles to part **A**. Make sure that the screw connection between **N** and **L** is loose enough that the access panel **D** remains movable.

The installer must use suitable dowels for the supporting structure (not included in the box) for fastening the ceiling mounting panels to the upper ceiling.

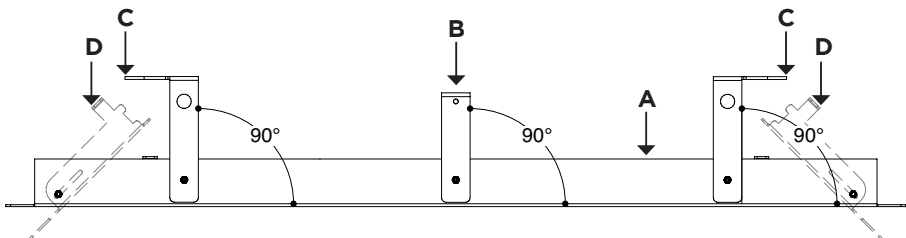

MOUNTING ON CEILING EXPERT & EXPERT XL



The installer must use suitable dowels for the supporting structure (not included in the box) for fastening the ceiling mounting panels to the upper ceiling.

The threaded rods must be shortened to the desired length on site. Observe the min. and max. lengths given on page 12.

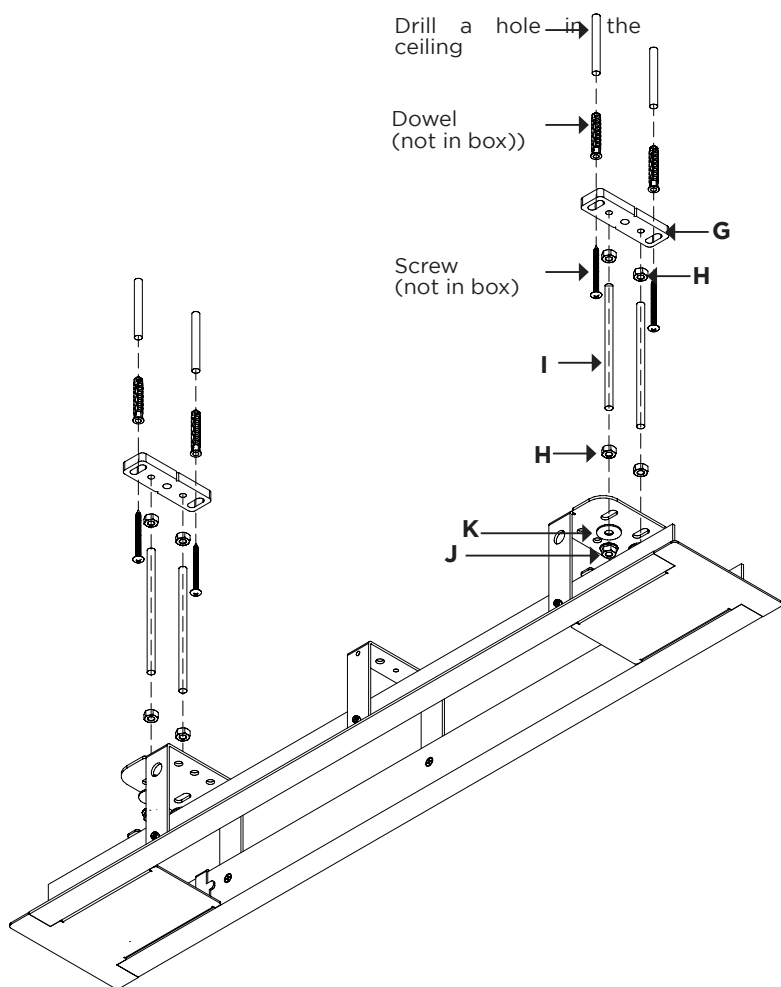

To fix the threaded rod **I** to the ceiling mounting plate **G**, turn nut **H** at least 20 mm onto the upper part of the threaded rod.

Screw the threaded rods into the ceiling mounting plates as far as they will go (at least 10 mm!). Then tighten the nut.

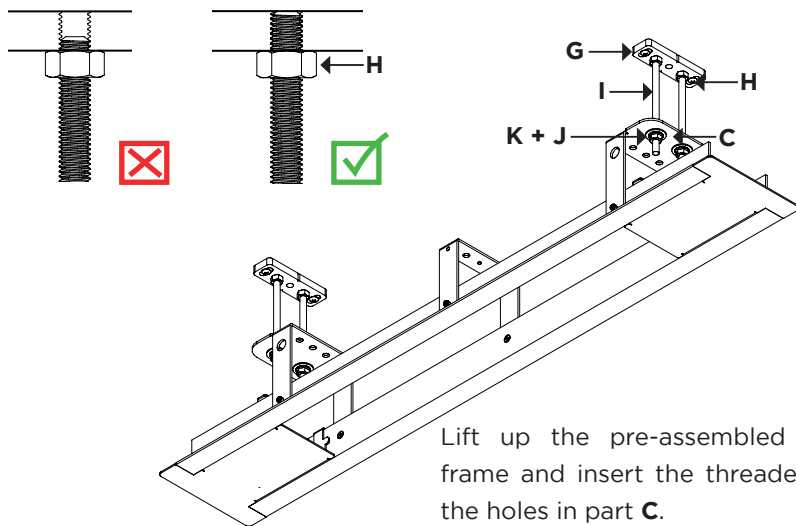

Lift up the pre-assembled installation frame and insert the threaded rods into the holes in part **C**.

Secure the mounting frame with washers **K** and collar nuts **J**.



Make sure that the lower part of the mounting frame is perfectly in balance. An installation of the mounting frame that is not levelled will result in malfunction and damage to the screen.

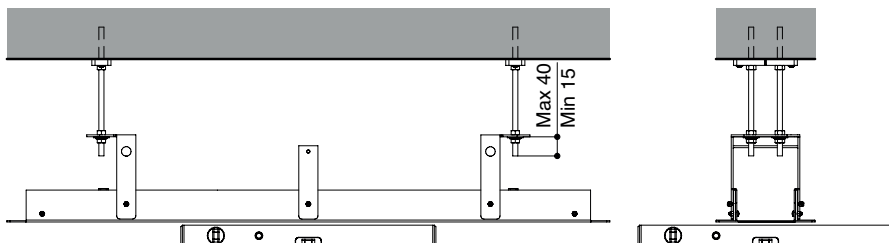

MOUNTING ON THE EXPERT & EXPERT XL MOUNTING FRAME



Before continuing with the installation of the screen, attach the mounting plates **E** and **F** as shown in the drawing. It is **IMPORTANT** to mount the right plate on the right side.

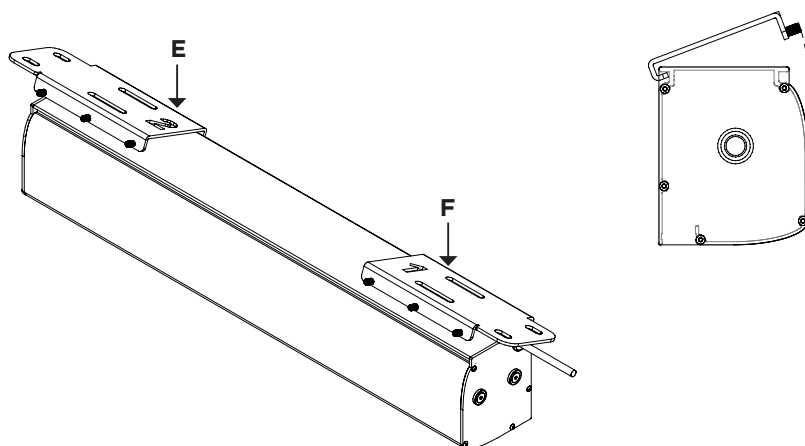

Before fixing the screws, make sure that the mounting plates **E** and **F** are positioned at the far end of the screen housing.

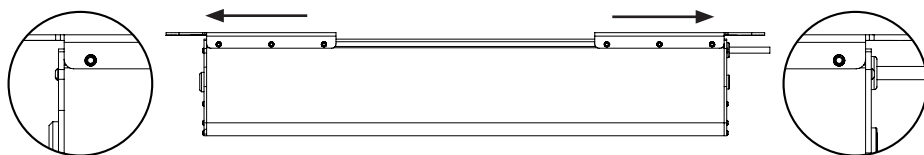

Now tighten ALL screws and check that both mounting plates are firmly connected to the screen housing.

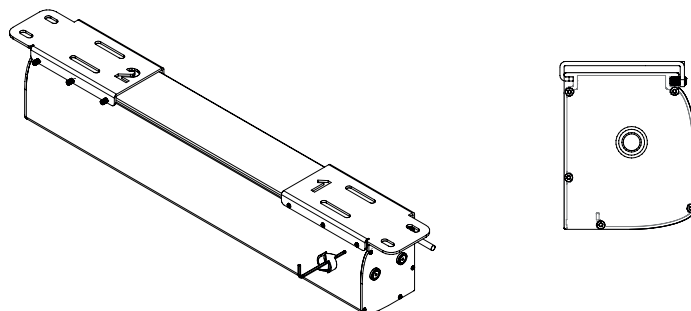

Now open the two inspection flaps to the vertical position.

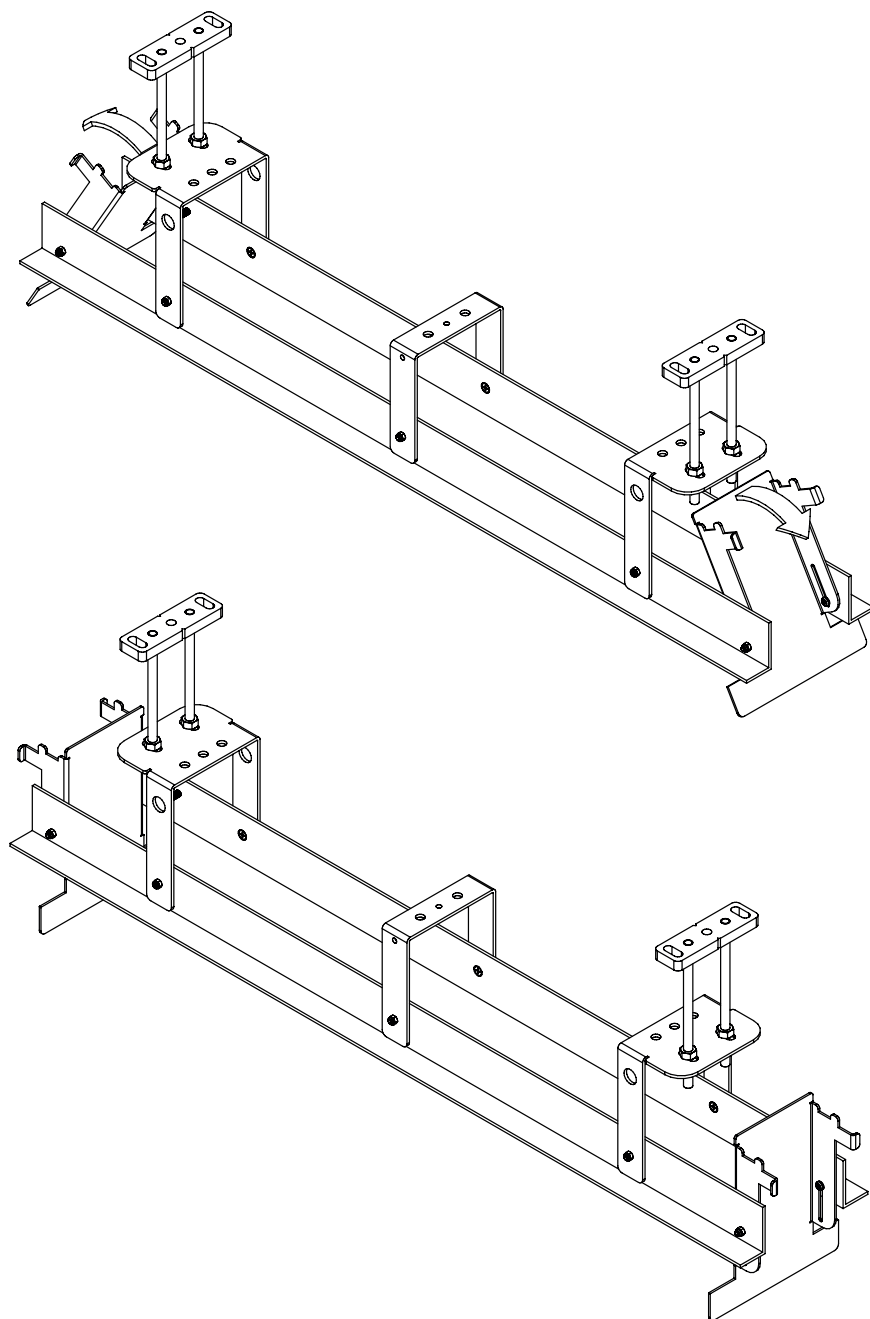

Lift the screen into the installation frame and guide the threaded rods through the holes in the mounting plates **E** and **F**.

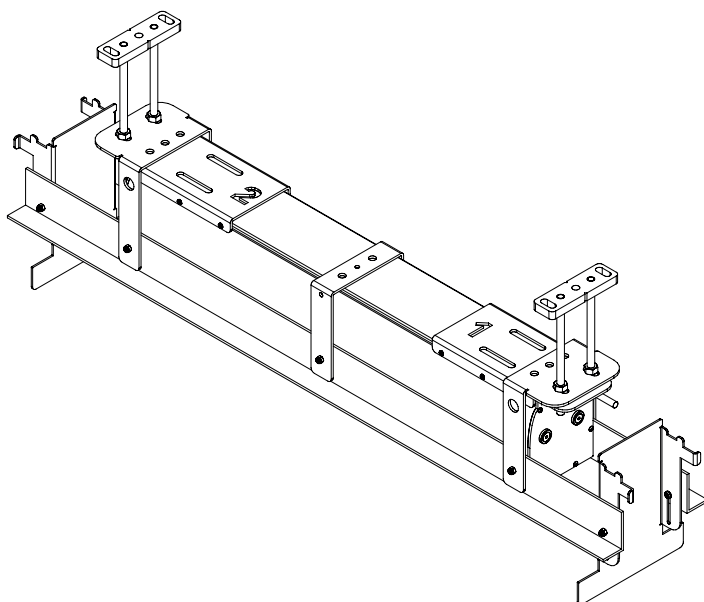
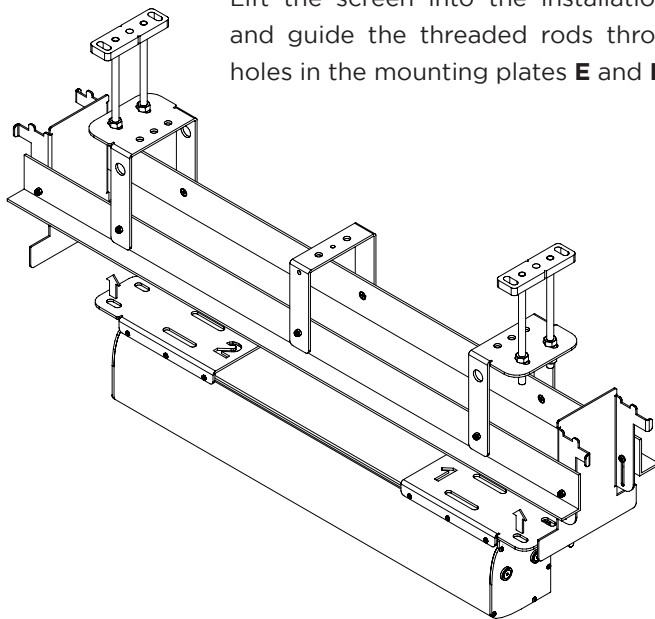

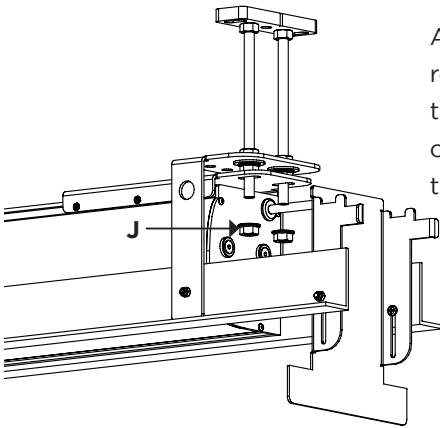

Attach the mounting plates to the threaded rods with the collar nuts J. Before tightening the nuts, make sure that the enclosure is centred in the ceiling mounting frame. Now tighten the collar nuts.

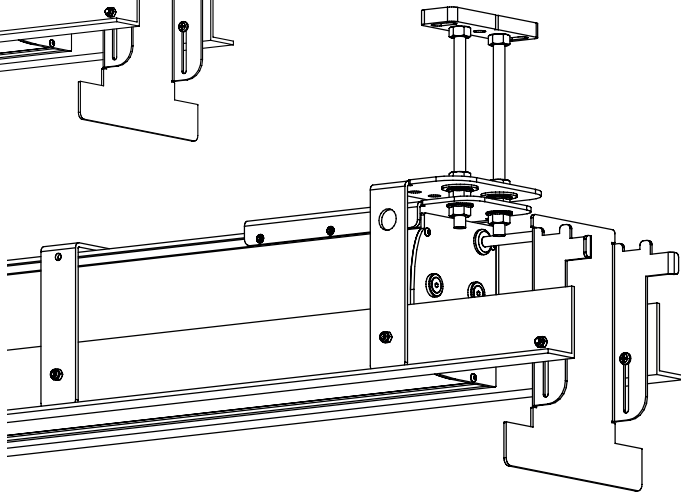

Now the electrical connection of the screen can be made by a specialist and the inspection flaps can be closed. This completes the installation.

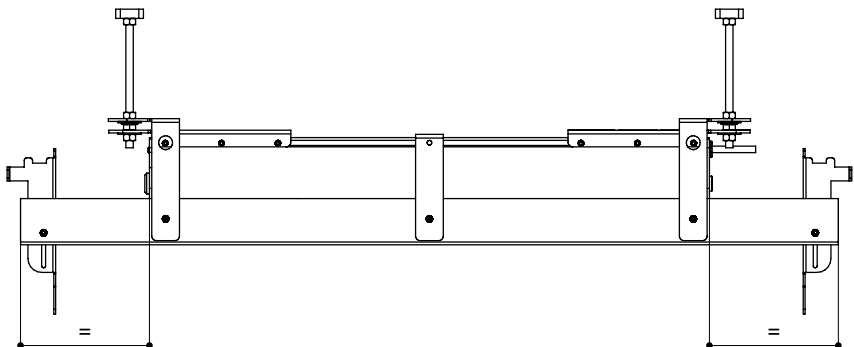

Now the electrical connection of the screen can be made by a specialist and the inspection flaps can be closed.

This completes the installation.

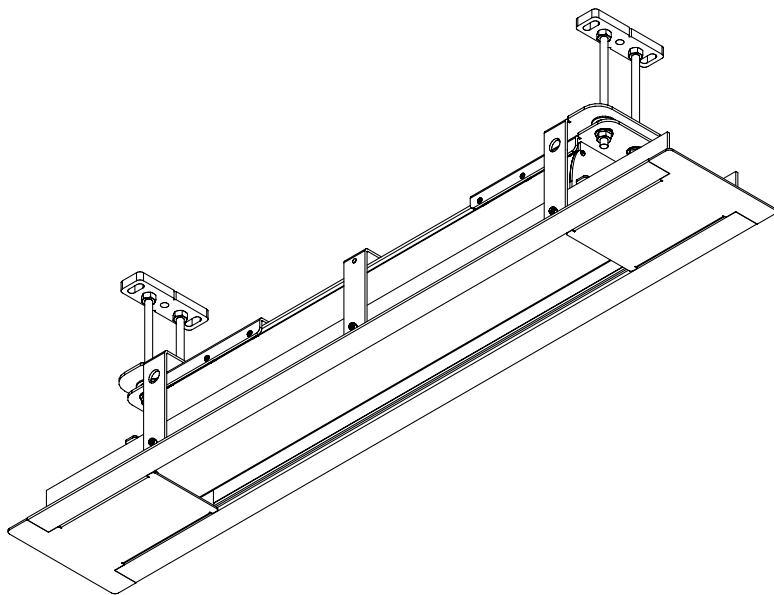
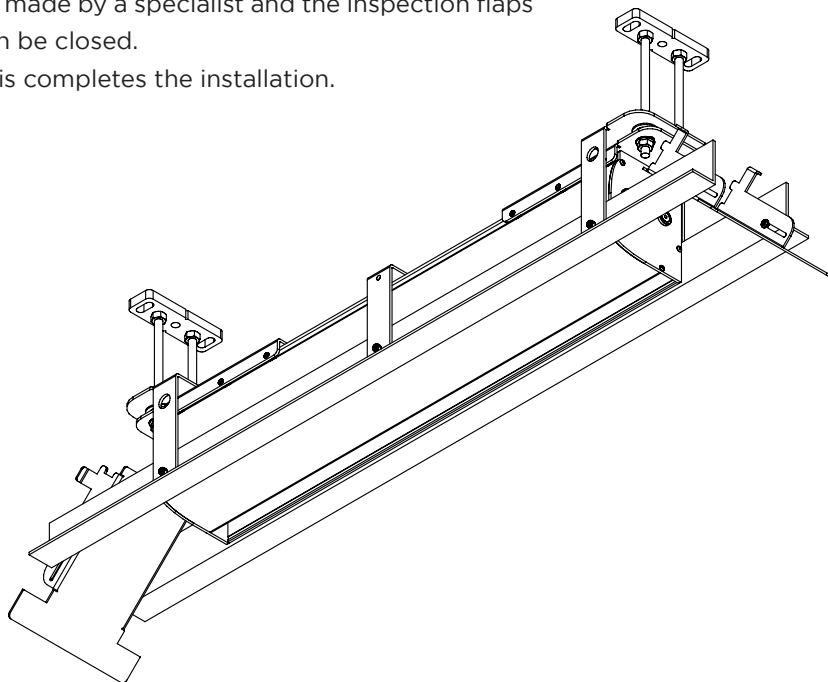

INFORMATION ON EU CONFORMITY

Manufacturer: celexon Europe GmbH
Address: Gutenbergstraße 2, 48282 Emsdetten, DE
Product name: celexon ceiling recessed screen Electric Expert | Expert XL

Products that are marked with the CE mark meet all requirements of the relevant EU directives. The EU declaration of conformity can be downloaded from the following address: www.celexon.de/zertifikate



The symbol indicates the separate collection of electricals in EU countries. Please do not throw the appliance into the household waste. Find out about the take-back system in force in your country and if you have any questions about the disposal process, contact your local authority or your local recycling and hazardous waste collection centre.

INFORMATION ON UK CONFORMITY

Manufacturer: celexon Europe GmbH
Address: Gutenbergstraße 2, 48282 Emsdetten, DE
Product name: celexon ceiling recessed screen Electric Expert | Expert XL

Products that are marked with the UKCA mark meet all requirements of the relevant UK directives. The UK declaration of conformity can be downloaded from the following address: www.celexon.de/zertifikate



The symbol indicates the separate collection of electricals in EU countries. Please do not throw the appliance into the household waste. Find out about the take-back system in force in your country and if you have any questions about the disposal process, contact your local authority or your local recycling and hazardous waste collection centre.