



Operating instructions

celexon Electric Economy



Thank you for purchasing this product.

For optimum performance and safety, please read these instructions carefully before connecting or operating this product. Please retain these instructions for future reference.

WARNINGS

The purpose of these operating instructions is to familiarise you with the operation of this product. Therefore, keep these instructions in a safe place so that you can refer to it at any time.

- Before installation, please refer to the enclosed data sheet for further safety and use instructions.
- Do not begin installation until you have read and understood the complete operating instructions.
- Carry out the installation with another person to ensure safe installation.
- Remove the product from its packaging and remove all packaging material. Make sure that there is no packaging material on or in the product. If you notice any damage to the packaging, also check whether there is any damage to the product. If you notice any external damage to the unit or any unexpected or unusual functioning, the product must not be used any further. Immediately contact the dealer from whom you purchased the product or celexon directly (Web: www.celexon.co.uk, Mail: info@celexon.co.uk) for further information.
- To ensure trouble-free operation, the product may only be used indoors. It is NOT suitable for outdoor use.
- The use of the appliance and accessories is forbidden to children under 16 years of age.
- Ensure that no children play with the appliance or are in the vicinity without supervision.
- Conversion or modification of the product impairs product safety.
- Caution: Risk of injury! Never open the product without authorisation. Never carry out repair yourself!
- Do not use the product near gas or water appliances or in a dusty environment.
- Handle the product with care. It can be damaged by knocks, blows or falling from even a small height.
- Keep the product away from moisture and heat.
- Never immerse the product in water or other liquids.
- Use the product only in its intended manner. Use for any other purpose may damage the product or its surroundings.
- Tighten the screws, but do not overtighten them. Overtightening the screws (e.g. by using a cordless screwdriver) can cause damage and affect the secure hold of the screen.
- Suspended loads must be checked for strength and load-bearing capacity at least

twice a year.

- Children should not use the screen or play under it unsupervised.
- Caution: Risk of injury! The unit closes flush and firmly in its retracted state, keep fingers, hands or other small parts away from the opening.
- All supply lines and cables must not be subjected to additional loads and must be laid in such a way that they are not damaged or crushed.
- Failure to observe the above instructions may result in personal injury and damage to the product or equipment connected to it. Incorrect installation or use may also invalidate the warranty.
- If you are unsure about the use of the product, please contact specialist personnel, your dealer or celexon directly (Web: www.celexon.co.uk, Mail: info@celexon.co.uk).
- Technical changes and errors expected.

The manufacturer accepts no responsibility for damage to property or personal injury, if the screen is used outside the recommended specifications, or in the event of improper installation. Do not use this screen in the vicinity of heaters or air conditioners. Also, do not mount the product in direct sunlight or in front of a window. Due to the temperature-sensitive PVC surface, the projection screen fabric may be permanently damaged.

We recommend that you wait approx. 2 hours after delivery before installing the projection screen. This way you will allow the screen to acclimatise, especially when moving from a cold to a warm environment (or vice versa).

Please avoid any stains on the surface of the screen. These may not be able to be removed

The positions of the end points are already optimally set at the factory and should not be changed. Especially with electric screens, the entire length of the fabric should always be used in order to achieve the best flatness. An adjustment of a few cm of the end points should only be made by persons with specialist knowledge and in consultation with the manufacturer. Incorrect adjustment can result in damage to the projection surface.

DISCLAIMER

The information in this document is subject to change without notice by the manufacturer. Changes will be added to subsequent versions of this manual. Errors expected.

CARE INSTRUCTIONS

NEVER clean the screen with alcohol or other cleaning agents containing solvents. Use only a soft and clean cloth. If necessary, dirt can be removed from the surface with a mild soap solution (max. 5%). It is essential to avoid contact with pointed or sharp objects. These could permanently damage the projection screen fabric. Further instructions can be found in the enclosed projection screen instructions.

TECHNICAL DATA

Voltage:	100 V ~ 120 V, 60 Hz 220 V ~ 240 V, 50 Hz
Consumption:	130 W (MAX) 0,4 W (Standby)
Control:	External infrared control box with remote control

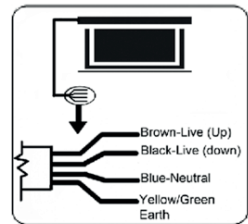

IN THE BOX



1x Screen

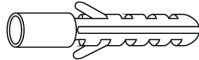

4x Plastic dowels



4x Screws



1x IR remote control incl. Batteries



4x nut

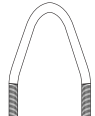

2x suspension loops

INSTALLATION NOTES

Install the screen in a position that is fully visible to all viewers! The optimum installation height corresponds to the position of the viewers in the centre of the screen with the screen fabric extended: eye level = lower third of the screen surface.

The screen can be installed on the wall/ceiling or hung from the ceiling on **closed** ring eyelets plus **screwable** karabiners (the eyelets are already on the side cap). For wall or ceiling installation only, the eyelets should be removed in advance). Please make sure that the metal shims are also used for wall and ceiling mounting, otherwise safe installation cannot be guaranteed). The enclosed installation material is intended for a solid stone wall. If necessary, obtain suitable mounting material for your installation surface.

MOUNTING ON THE CEILING (VIA EYELETS)*

Attach the eyelets to the two side caps and measure the distance between them. Mark the points on the ceiling and make sure that the eyelets are aligned with each other and parallel to the wall. Pre-drill the holes at the markings with the right diameter drill bit for the hooks and mounting material, fix them to the ceiling and hang the screen.

* Electric Economy screens with a cloth width greater / equal 240 cm have the eyelets already integrated in the metal side cap as a hole. Here, ring eyelets and snap hooks are required. Make sure that the mounting materials are sufficient for the load!

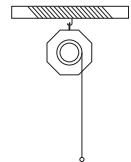

MOUNTING ON THE WALL

Measure the distance between the holes in the side caps (two per cap) and transfer them to the wall.

Drill the holes at the markings with the holes with the right diameter for the mounting material and make sure that the drill holes are absolutely level (Use a spirit level!).

Use dowels and screws that are suitable for your mounting surface. Screw the two upper screws into the wall most of the way and hang the screen from both sides into the upper hole.*

Make sure that the screen is installed straight and level. Tighten the screws and then tighten the lower screws on both sides of the screen.

Caution: Do not overtighten the screws! If you notice cracks in the caps they must be replaced! The screen must not be used with cracked caps. Please ensure that the metal shims are also used for wall and ceiling mounting, otherwise a safe installation cannot be guaranteed).

*** Electric Economy series screens with a cloth width greater / equal 240 cm: Tighten the screws - the installation is now complete.**

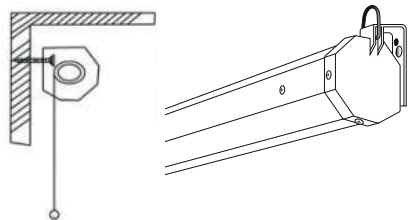
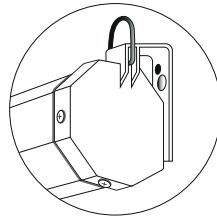
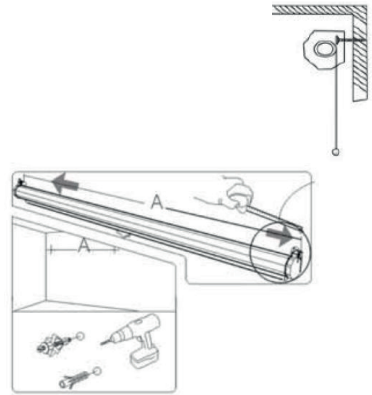

OPERATION

CONTROL VIA THE WALL CONTROL BOX

STEP 1: SAFETY CHECK (FIG. 1)

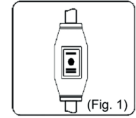

Insert the plug into the socket (ensure correct voltage). The cable must not be laid on hot surfaces or stretched. When using an extension make sure it has the correct specification. The wall control box must be mounted with the cable outlet on the underside.

STEP 2: EXTEND THE SCREEN (FIG. 2)

Press the downward pointing arrow button. The screen extends and stops automatically at the set end point. Make sure that no objects or persons obstruct the extension path of the screen.

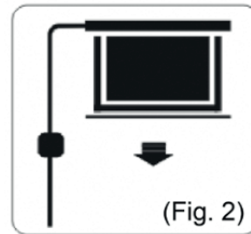

STEP 3: RETRACT SCREEN (FIG. 3)

Press the arrow key pointing upwards. The screen retracts and stops automatically at the housing or the set upper end point. Make sure that no objects or persons obstruct the retraction of the screen.

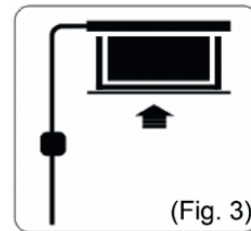

STEP 4: STOP THE SCREEN

To stop the screen manually, press the stop button between the arrows.

CONTROL VIA THE REMOTE CONTROL



STEP 1: SAFETY CHECK (FIG. 1)

Insert the plug into the socket (ensure correct voltage). The cable must not be laid on hot surfaces or stretched. When using an extension make sure it has the correct specification.

The wall control box must be mounted with the cable outlet on the underside.

STEP 2: EXTEND THE SCREEN (FIG. 2)

Press the downward pointing arrow button. The screen extends and stops automatically at the set end point. Make sure that no objects or persons obstruct the extension path of the screen.

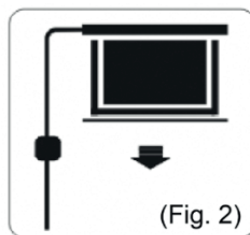

STEP 3: RETRACT THE SCREEN (FIG. 3)

Press the upward pointing arrow button. The screen retracts and stops automatically at the housing or the set upper end point. Make sure that no objects or persons obstruct the retraction of the screen.

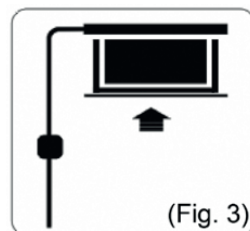

STEP 4: STOP THE SCREEN

To stop the screen manually, press the stop button between the arrows.

It is possible to set the stop points. Please request the instructions for this procedure from your specialist dealer or directly via www.celexon.com

INFORMATION ON EU CONFORMITY

Manufacturer: celexon Europe GmbH
Address: Gutenbergstraße 2, 48282 Emsdetten, DE
Product name: celexon Electric Economy

Products that are marked with the CE mark meet all requirements of the relevant EU directives. The EU declaration of conformity can be downloaded from the following address: www.celexon.de/zertifikate



The symbol indicates the separate collection of electrical and electronic devices in EU countries. Please do not throw the device into household waste. Find out about the return system applicable in your country and contact your local authority or your local waste and pollutant collection point if you have any questions about the disposal process.

INFORMATION ON UK CONFORMITY

Manufacturer: celexon Europe GmbH
Address: Gutenbergstraße 2, 48282 Emsdetten, DE
Product name: celexon Electric Economy

Products that are marked with the UKCA mark meet all requirements of the relevant UK directives. The UK declaration of conformity can be downloaded from the following address: www.celexon.de/zertifikate



The symbol indicates the separate collection of electrical and electronic devices in EU countries. Please do not throw the device into household waste. Find out about the return system applicable in your country and contact your local authority or your local waste and pollutant collection point if you have any questions about the disposal process.